

V I A P A V I A

M A R C I A P I E D E

M A R C I A P I E D E

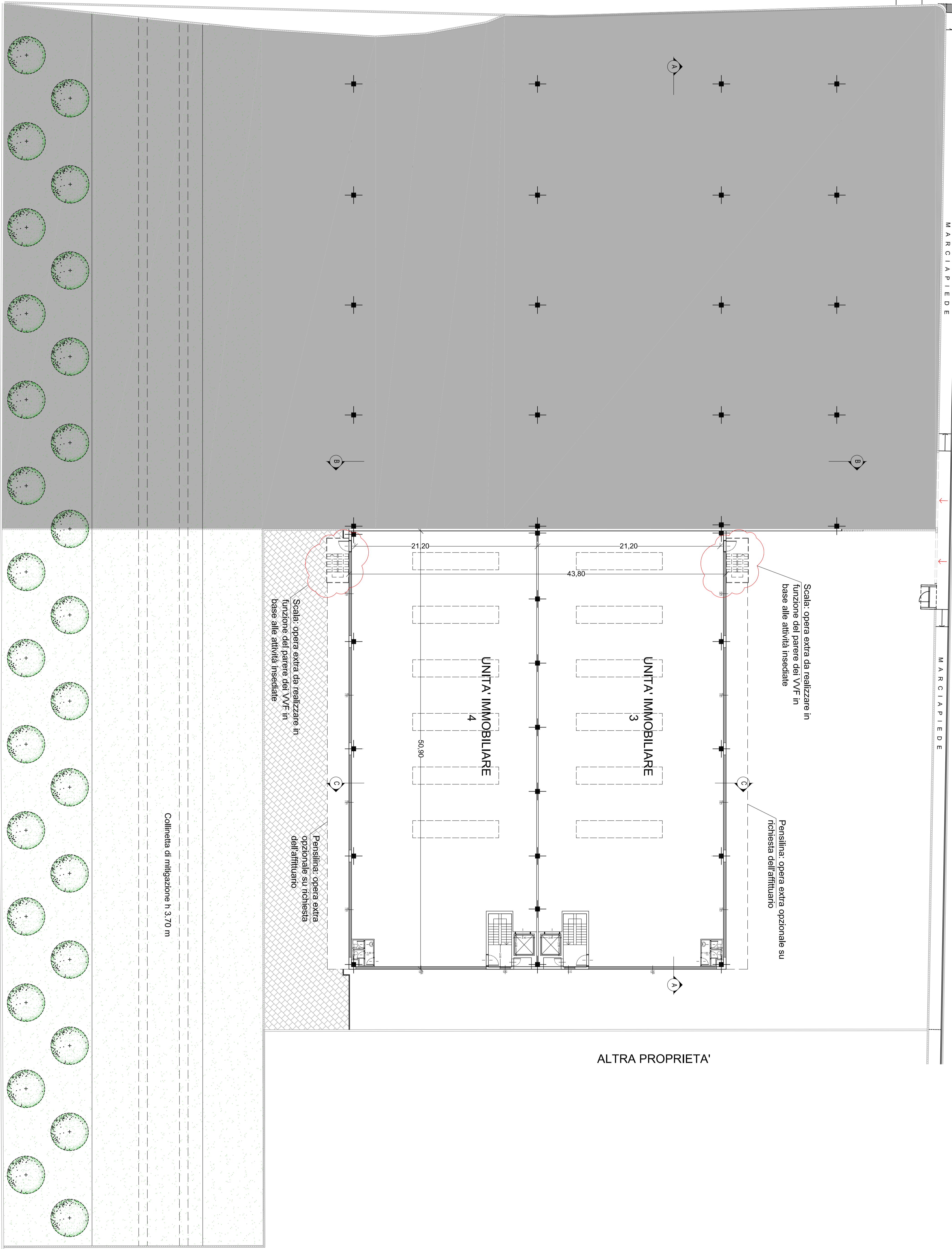

ALTRA PROPRIETA'

| | |
|---|--------|
| Studio Lomati & Balconi | |
| Ing. Marco Lomati Ing. Rossella Balconi Geom. Alberto Balconi | |
| Piazza Viviani, 4 c.a.p. 20134 Nova Milanese (MB) - tel. 0362/4114 - 0362/45091 | |
| DATA | SCALA |
| 29.07.2021 | 1:200 |
| COMMITTENTE | |
| SOCIETA' PERLACORALLO S.R.L. | |
| PROGETTO | |
| EDIFICIO AD USO INDUSTRIALE | |
| MISGSO | |
| TAVOLA | NUMERO |
| PIANTA PIANO PRIMO | B |